

- 1.- Wall fastening screw holes.
- 2.- Connection terminals
- 3.- Holes for support
- 4.- Support
- 5.- Screws for support

### DESCRIPTION

2-way reflex baffle, 8 Ohm/30 W (80 W.max.) with 5 ¼ " speaker and ½" tweeter.

Front metal grille and moveable support.

It has pressure terminals for simple connection.

Finish in black.

Model P7351 differs because it has been prepared for outdoor installation: Aluminium grille, steel screws, support with corrosion protection and UV paint.

### INSTALLATION

The ideal location for the baffles depends on the size, shape and decoration of the room.

The best stereo effect is obtained when the baffles are separated 2 to 4 metres from each other and are placed at ear height.

It can be installed on any piece of furniture or shelf and can also be hung from the wall with screws or with the moveable support.

Model P7351 is prepared for outdoor work. Anyway, try to install it in a sheltered place and move it to prevent water from entering the inside of the baffle (through the reflex tube on the front of the speaker). *Support installation:*

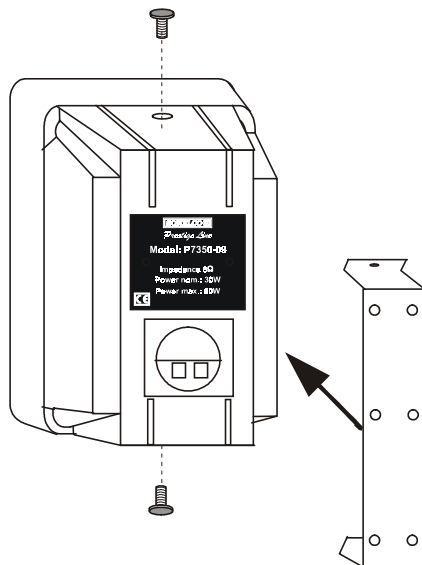

### CONNECTION

Before making the connection, make sure that the amplifier supplying the audio signal is off.

After putting the baffles into place, prepare the cables according to desired measurement and make the connection.

**Terminals :**

**RED: Input+**

**BLACK: Input-**

### TECHNICAL CHARACTERISTICS

- 2-way reflex baffle
- 5 ¼ " speaker
- ½" dome tweeter
- Rated power: 30 W RMS (80 W max.)
- Rated impedance: 8 Ohm.
- Frequency response: 100 Hz – 20 KHz
- Sensitivity (1W/1m): 88 +/- 3dB.
- Dimensions: 170 x 265 x 165 mm. (Width x Height x Depth)
- Weight: 2.250 Kg.

**Only in Model P7351 (for outdoors):**

- UV paint
- Aluminium grille.
- Steel screws
- Support with corrosion protection.

*Note: If the baffles are placed next to a TV set, and they have a certain effect on the colour purity, separate them slightly.*