

1.- Infrared receiver. 2.- Operation indicator LED. 3.- Mono/stereo switch. 4.- On/off message switch. 5.- IR module. 6.- Message receipt level regulation. 7.- 5+5W amplifier module. 8.- Audio amplifier output level regulation. 9.- IR connector. 10.- IR connector (9) pass hole. 11.- IR module female connector.

### DESCRIPTION

8" diffuser with 10W monophonic amplifier and infrared remote control. Configuration can be selected by 2 switches, from 2 stereo channels to 4 mono channels and message receipt, sleep and special piped music effects.

### GENERAL CHARACTERISTICS

- Adjustable message receipt level. By means of potentiometer (6).
- Level adjustment (8). In amplifier module (7). (Factory preset).
- Regulated audio output for DCH channel additional speaker, (P6242).
- Configuration selected by two switches. Mono/Stereo (3) and On/Off messages (4) of IR module, being able to receive general message and by zone. See table.
- Infrared remote control by control P4802. Includes luminous operating indicator that blinks on and off when receiving orders from the remote control.
- The following functions can be carried out from the IR control:
- On/Off and channel change
- Adjustment of: Volume, Bass, Treble and Balance.
- Ideal sound mode (volume, balance, bass and trebles)
- Special sound effects: Mono, Pseudo-Stereo, Stereo and Stereo-Spatial.
- Sleep function. 20 minute timing after which the module will automatically disconnect. Whilst the timing last the LED will periodically blink on and off.
- The sleep function can be cancelled just by switching off the module and switching it on again.
- Scan function. This permits, from the control, changing the tuned station from any point of the installation.
- Mute function: Setting the volume to minimum.

### CONNECTION

The Mono/Stereo (3) and On/Off message (4) switches must be configured according to the type of installation made, see Table.

**Note: The manipulation of the switches is only effective with the active speaker without supply! Therefore, to change the configuration:**

- 1.- switch the Unit off or slacken the connections 2 and 02 of the active speaker
- 2.- place the switches in the right positions.
- 3.- switch the Unit on or connect 2 and 02 of the active speaker

-Once connected, an internal test process is generated, which results, if everything is OK, in the LED blinking on and off before entering into Standby state. Then the active speaker is ready for handling.

Its connection is made directly to the distribution line of the installation by means of the IR module strip (5). In rooms where you wish stereo sound, an active speaker P8242 will be installed together with an active speaker Mod. P6242

### TECHNICAL CHARACTERISTICS

8" speaker: Frequency response 90 Hz – 12 kHz. (-3dB)  
Sensitivity: 90 dB (1kHz-1W-1m)

Supply voltage: 16 Vdc  
Power: 10W RMS  
Distortion: 0.8%  
Consumption: 1A,  
S/N Ratio: 57 dB

		Possible configuration			
		2 stereo channels	1 stereo+1 mono + message receipt	4 mono channels	3 mono channels + Message receipt
MODULE STRIPS	IR	Mono - Stereo	Stereo	Stereo	Mono
	IR	Messages Yes-No	Messages No	Messages Yes	Messages No
	IR	15	Input channel 1 Left	Input channel 1 Left	Input channel 1
	IR	16	Input channel 1 Right	Input channel 1 Right	Input channel 2
	IR	25	Input channel 2 Left	Input channel 2 Mono	Input channel 3
	IR	26,7	Input channel 2 Right	Message or alarm signal	Input channel 4
	IR	8		Area selection input cont. Logic	Message or alarm signal
	IR	9R		Gen. Call receipt cont. Logic	Area selection cont. Logic
	IR	0	Scan	Scan	Gen. Call receipt cont. Logic
	IR	2	Supply	Supply	Scan
AMPLIF.	02	Supply	Supply	Supply	Supply
	4	Ground	Ground	Ground	Ground
	3	16V output (To connect to terminal 3 of Additional Act.speaker P6242 in stereo installation )			
	05	Do not connect			
	06	Right channel Audio regulated output ( To connect to terminal 3 of Additional Act.speaker P6242 in stereo installation )			

### INSTALLATION OF ACTIVE SPEAKERS WITH GRILLE P4951:

- 1.- With the aid of a screwdriver slightly open the last groove of the grille and insert the infrared capsule cable (fig. 1), correctly position the capsule, unstick the adhesive paper and press lightly on the grille for a few seconds (fig. 2).
- 2.- Pass connector (9) of the IR receiver through the hole (10) of the support ring.
- 3.- Connector the connector (9) in the female connector (11) of the IR module

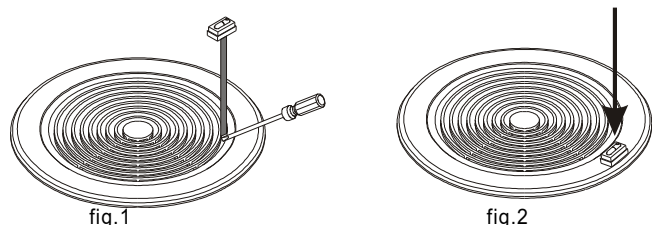

fig.1

fig.2