

4FA009101

ANALOGICAL ADJUSTMENT CONTROL PC1105

1 MONO MUSIC CHANNEL WITH MESSAGE RECEIPT



- 1 - Volume adjustment potentiometer
- 2 - ON/OFF push-button
- 3 - Operation indicator light
- 4 - SCAN push-button
- 5 - Message receipt level adjustment

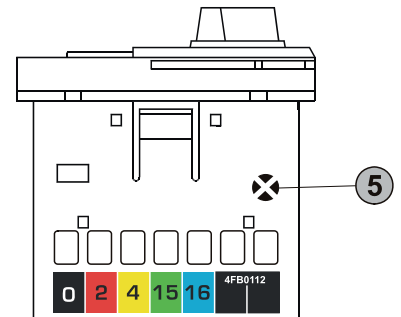
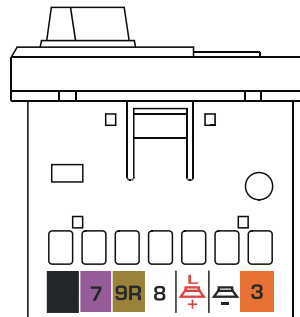
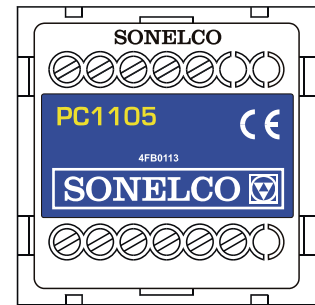

DESCRIPTION

1 W mono amplified control with message receipt and scan function.

GENERAL CHARACTERISTICS

- Electronic ON/OFF
- LED type operation indicator light
- Volume control by potentiometer
- 1 W mono amplifier with output for standard 8 Ohm speaker
- Scan function, (remote change of radio station in a SONE LCO tuner)
- Message receipt, even when the control is switched off
- Adjustable message receipt volume, regardless of the audio volume of the music channel
- Telecontrol system by voltage

CONNECTION

Before connecting, make sure the system's main power supply unit is switched off. Insert the control in the metal base plate and make the connection according to the following instructions:

TERMINALS

- 0 - Scan line. Connect to relative Scan line on tuner which you wish to control
- 2 - Input + 16V supply
- 3 - Output + 16 V, after switch
- 4 - Ground
- 5 - Left channel input
- 6 - Right channel input
- 7 - Message audio input
- 8 - Area selection input
- 9R - General call input. Connect to wire 9
- L+ - Output for speaker
- - Speaker ground

NOTE: The system must be wired up separately from the electricity mains, according to regulations.

OPERATION

After making the connection, switch the main unit on. Make sure there is an audio source connected to the main unit (a tuner or another external audio source).

If a telecontrol is used make sure the main unit uses the telecontrol by voltage (see information on main unit).

Place the volume potentiometer (1) at a medium level. Switch the control on with the ON/OFF push button (2) and check the pilot light (3) comes on. You will hear the audio source connected to the main unit.

Set the volume to the desired level. Message receipt is priority and you can receive the messages even though the control is off. The message receipt volume does not depend on the outside volume adjustment potentiometer (1). The message level can be adjusted by means of potentiometer (5) on the rear of the control.

Scan Function

If the audio signal comes from a SONE LCO tuner and the SCAN line is connected, you can select the station by applying the SCAN push-button.

Note: The application mode of the SCAN function depends on the tuner used. See relative tuner manual.

TECHNICAL CHARACTERISTICS

- Supply voltage: 16 V DC
- Maximum consumption: 200 mA
- Rated output power: 1 W RMS
- Output impedance: 8 Ohm
- Maximum output power: 1.5 W RMS
- Maximum output current (Terminal 3): 1 A
- Frequency response: 80 Hz-20 KHz. (-3dB)
- Signal/Noise ratio: 74 dB
- Input sensitivity (Terminals 5, 6, 7): 1.5 V
- Crosstalk: 60 dB
- Rated input level for message commutation: 15 V

Dimensions: 45x45x47 mm. (L x W x D)

Weight: 50 grams

INSTALLATION EXAMPLE

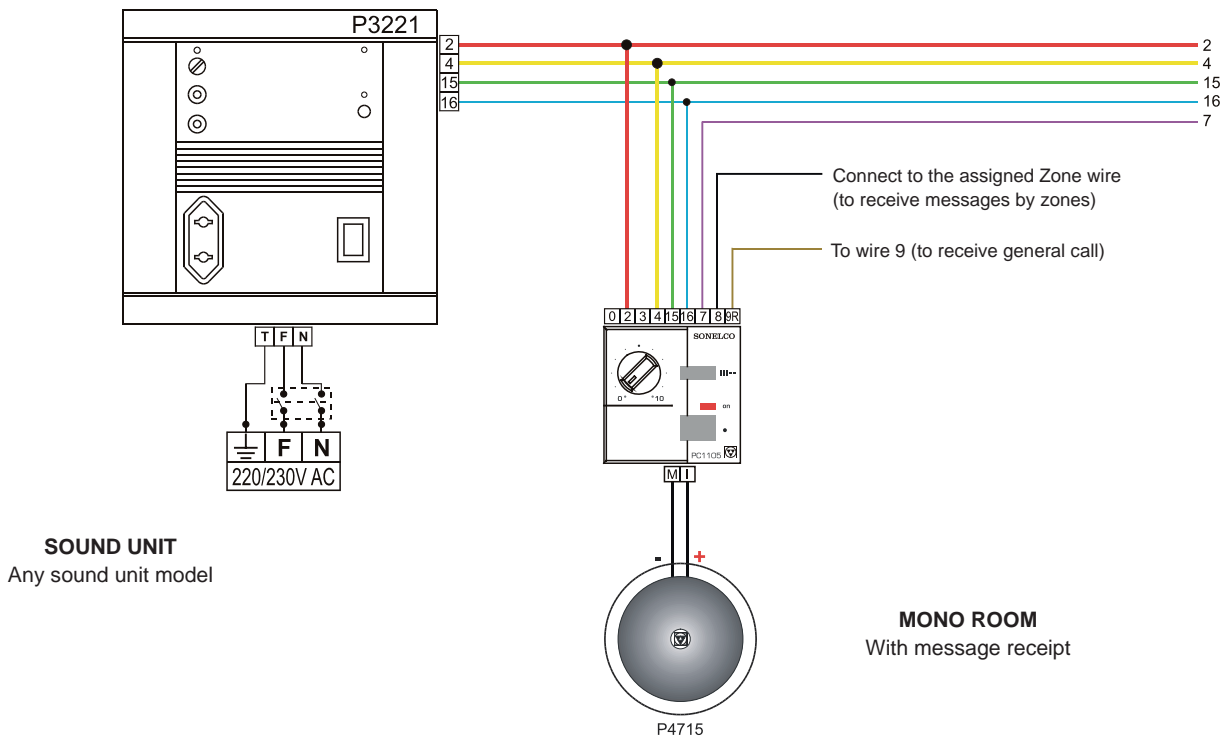

ASSEMBLY RECOMMENDATIONS: All the "Prestige Line" series models can be put into place in various types of flush fitted boxes, for which we have several types of front frames available, that can be delivered separately. For further details please www.sonelco.com