

2-CHANNEL DOMOTIC CONTROL PCD1308 AND CALL RECEIPT

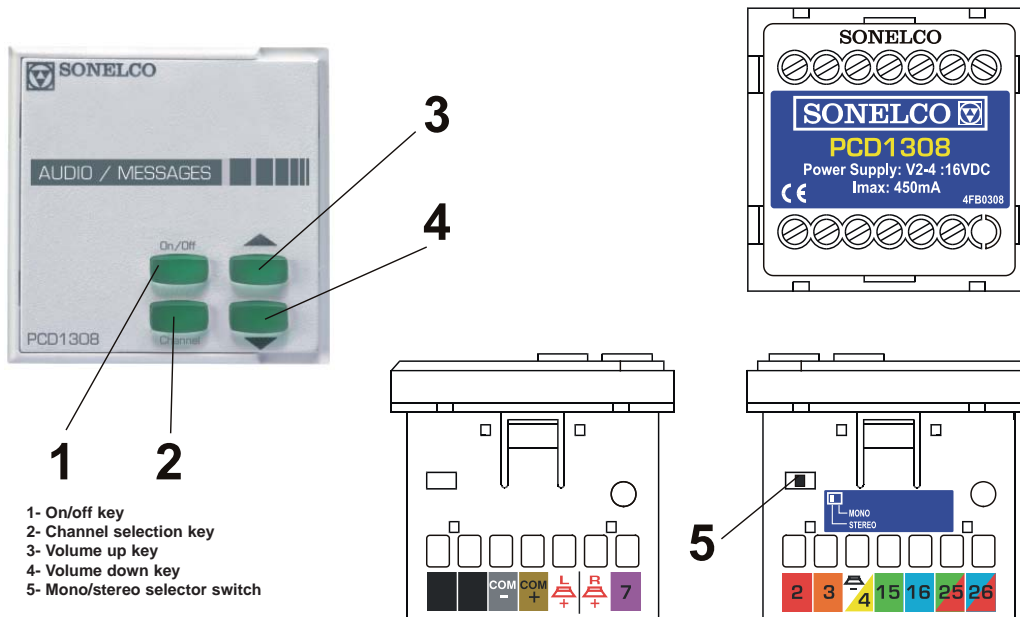

- 1- On/off key
- 2- Channel selection key
- 3- Volume up key
- 4- Volume down key
- 5- Mono/stereo selector switch

DESCRIPTION

2-channel stereo control with call receipt through domotic bus

GENERAL CHARACTERISTICS

- Illuminated keypad when music is being played or a call is being received.
- Maximum of 200 zones
- 20 zone groups
- Zone number and name assignment from a PD5807.
- Attachment to each one of the 20 groups made from a PD5807.
- Off function from a PD5807 or PCD1307

CONNECTION

Before proceeding to make the connection make sure that the power supply unit is off. Insert the control in the metal base plate and make the connection according to the following indications:

TERMINALS:

- 2- Input + 16V power supply
- 3- Output +16V after switch
- 4- Ground
- 7- Message audio input
- 15- Left channel 1 input
- 16- Right channel 1 input
- 25- Left channel 2 input
- 26- Right channel 2 input
- COM+ - Communications bus
- COM- - Communications bus
- L- Left speaker output
- R- Right speaker output

NOTE: The system wiring must be installed separately from the electrical mains, according to regulation.

Once the system has been wired up, the next step must be to award a zone number to each one of the modules, PD5807, PCD1308 or PCD1307. To do this, bear in mind that this operation is carried out on the actual module in the case of PD5807, from a PD5807 in the case of the PCD1308 and from a PD5807 or on the actual module for the PCD1307. There must always be a zone 1 and it is advisable for the zones to be consecutive.

OPERATION

The module leaves the factory without any zone number or name and without being attached to any of the 20 configurable zone groups. When the zone assignment process is launched from a PD5807 with a certain zone number all the PCD1308 of the system will start to beep and when you press any key of a PCD1308 you will assign it the elected zone, going on to the next zone afterwards.

Once the module has a zone number the name of the zone can be changed from a PD5807, determining which groups it is attached to.

If you wish to change the zone number, first remove the number it already has by keeping the Channel and Down keys pressed until you stop hearing the beep.

The music is switched on and off with the On/Off key; the module starts up with the music off.

The CHANNEL key is used to change between the 2 channels. The volume of the music or of the call receipt can be changed with the Up/Down keys depending on whether you are listening to music or receiving a call at that time. The call receipt volume is stored for the next one

TECHNICAL CHARACTERISTICS

- Power supply voltage: 16Vdc
- Maximum consumption: 450 mA
- Standby consumption: 35 mA
- Rated output power: 1+1" RMS (8 Ohm output impedance)
- Maximum output power: 1.5+1.5W RMS
- Distortion < 1%
- Maximum output current (Terminal 3): 2 A
- Frequency response (-3 dB): 90 Hz-18 kHz
- Signal/Noise ratio: >55 dB
- Input sensitivity (Terminals 15, 16, 25, 26): 1.1 V
- Crosstalk: 38 dB
- Message audio input sensitivity (Terminal 7): 1.2 V

Dimensions: (L x W x D): 45x45x45 mm.
Weight: 30 grams

INSTALLATION RECOMMENDATIONS

- 1- If possible, the installation with this type of controls must be made in one single line and without branches.
- 2- For it to work correctly, the maximum total length of a line of controls must not exceed 1200 metres.
- 3- It is advisable to install a line repeater module, PCD3815, if there are any branches or unions between several lines.

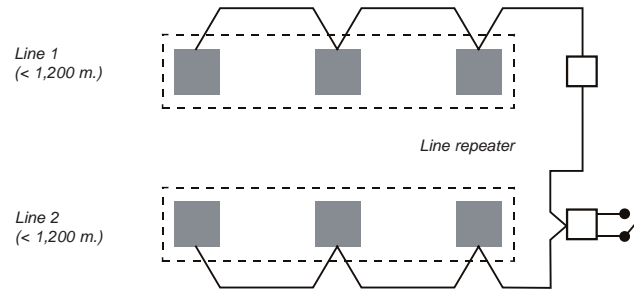

INSTALLATION EXAMPLE

