

4FA020801

## ANALOGUE CONTROL UNIT - PE1180

4 STEREO MUSIV CHANNELS WITH MESSAGE RECEIPT



- 1 - Volume adjustment potentiometer
- 2- ON/OFF pushbutton
- 3 - Operation indicator light
- 4.- Selected channel indicator light
- 5.- Pushbutton for changing music channel
- 6.- Message receipt level adjustment
- 7 - Mono/stereo M/S switch

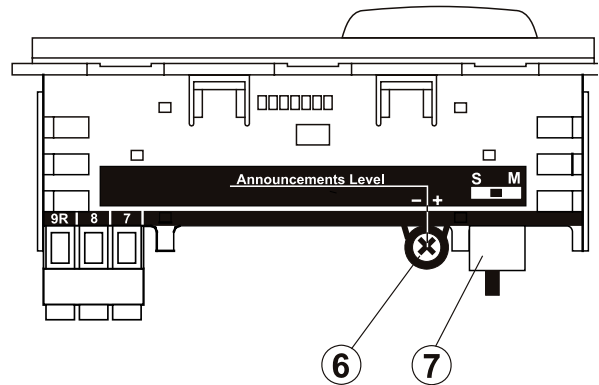
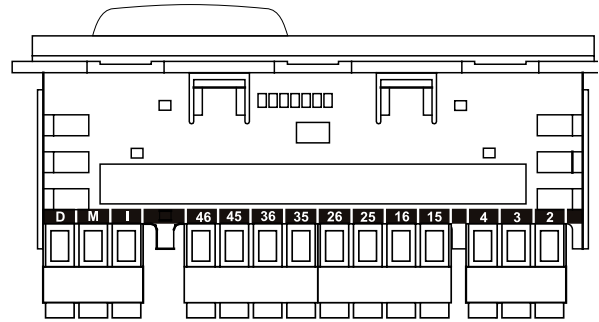

### DESCRIPTION

1+1 W stereophonic amplified control unit with potentiometer (1) to adjust volume. 4 music channel selector and message receipt. Electronic on/off by pushbutton. Switch (7) to select mono or stereo operating mode and internal setting of message receipt level (6).

### GENERAL CHARACTERISTICS

- Electronic switch with "on/off" pushbutton (2)
- LED type operation indicator light (3)
- Volume control by potentiometer (1)
- Electronic switch for 4 stereo music channels (5)
- Channel no. indicator light (4)
- Memory of last channel selected
- Mono/Stereo switch "M/S" (7)
- 1+1 W stereo amplifier with output for standard 8 Ohm speaker
- Message receipt, even when the control is switched off with internal setting to adjust the receipt level which is independent of music volume
- Telecontrol system by voltage through audio line

### CONNECTION

Before connecting, make sure the power supply unit is switched off. Insert the control in the metal base plate and make the connection according to the following instructions:

#### TERMINALS

- 2 - Input + 16V supply
- 3 - Output + 16 V, after switch
- 4 - Ground
- 7 - Message audio input
- 8 - Zone selection input
- 9R - General call input. Connect to wire 9
- 15 - Channel 1 audio input Left
- 16 - Channel 1 audio input Right
- 25 - Channel 2 audio input Left
- 26 - Channel 2 audio input Right

- 35 - Channel 3 audio input Left
- 36 - Channel 3 audio input Right
- 45 - Channel 4 audio input Left
- 46 - Channel 4 audio input Right
- M - Common ground for speakers
- I - Output for left speaker
- D - Output for right speaker

**NOTE:** The system must be wired up as far as possible away from the electricity mains

### OPERATION

After making the connection, switch the main unit on and make sure there is an audio source connected to the main unit (a SONELCO tuner or another external audio source). If the control unit is installed with a 4000 Series main unit, and the telecontrol is used, make sure the main unit uses the telecontrol by voltage (see information on main unit). Check the position of the mono/stereo switch (7). If both speakers have been installed in that room the switch will be placed on "S" (stereo), position by defect. In the event that only one speaker has been installed the switch will be placed on "M" (mono).

To switch the control on depress the "on/off" switch (2) and check that the pilot light (3) comes on. This control is designed for systems with 1 to 4 channels, to select the channel depress the "channels" switch (5) (the pilot light corresponding to the channel no. selected will come on). Set the volume to the desired level with potentiometer (1).

To switch the control off depress the "on/off" switch (5) and check that the LED (3) has gone off.

### MESSAGE RECEIPT

Message receipt is priority and you can receive the messages even though the control is off. The message receipt volume does not depend on the outside volume adjustment potentiometer (1), it leaves the factory pre-set in an intermediate position. If required, it can be changed with potentiometer (6).

Make a call to this zone from a message transmitter control and check that the message is heard correctly..

## TECHNICAL CHARACTERISTICS

Supply voltage: 16 V DC  
 Maximum consumption: 460 mA  
 Rated output power: 1+1 W RMS  
 Output impedance: 8 Ohm  
 Maximum output power: 1.5 +1.5W RMS  
 Maximum output current (Terminal 3): 1 A.

Frequency response: 80 Hz-22 KHz.  
 Frequency response message input: 80 Hz-22 KHz  
 Signal/Noise ratio: >70 dB  
 Rated input level for message commutation: 15V  
 Input sensitivity (Terminals 15,16,25,26,35,36,45,46): 1.5 V  
 Input sensitivity (Terminal 7): 1.8 V

Outer dimensions (LxWxD): 106x59x51  
 Weight: 90 grams

## INSTALLATION EXAMPLE

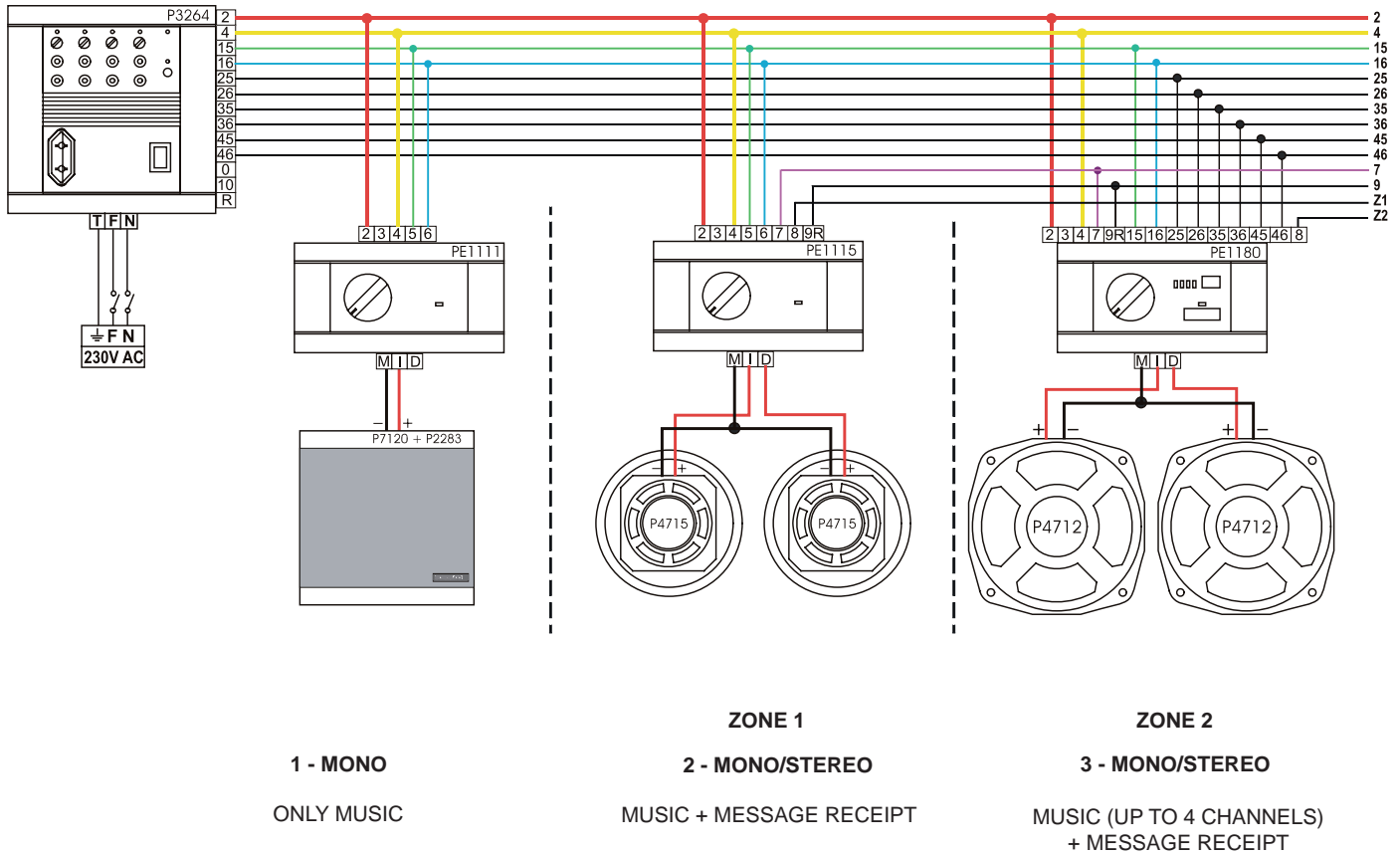

**NOTE:** Apart from the speakers fitted on the diagram, any other kind of 8 Ohm. speaker from our catalogue can be installed, as well as active speakers and power amplifiers.

**ASSEMBLY RECOMMENDATIONS:** All the "PRESTIGE" series modules can be fitted on the flush-boxes indicated below, for which we have the front frame specified below. This frame is supplied separately

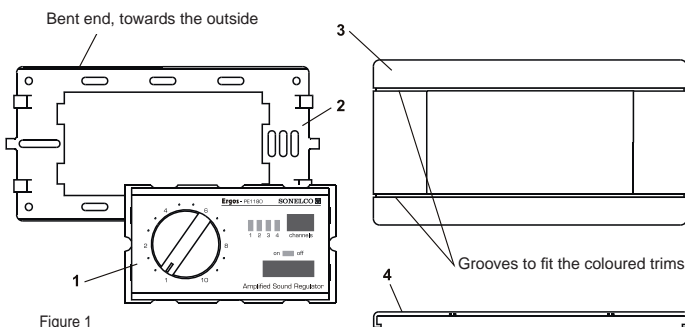

**RECTANGULAR FRONT FRAME FOR "SONELCO" BOX or DOUBLE UNIVERSAL BOX:** To assemble the control, place the base plate as shown in figure 1, with the bent edge towards the side where the control is inserted.

In this position, gently place control (1) over base plate (2) until a click is heard. After making the connection and carrying out the operation tests, secure the base plate onto the flush-box.

Finally fit the outside frame (3) pressing on the base plate until it is adjusted. If trims (4) are mounted, do this before fitting the frame, first inserting one of the ends into the groove and pressing to insert it completely.

KM9200-01 (WHITE) KM9200-02 (CHARCOAL) KM9200-03 (TWO-TONE)

These characteristics are only given as reference. The manufacturer reserves the right to introduce any amendments without prior notice in order to improve the product.

REVISADO  
 Por GERARDO fecha 10:12 , 26/05/2008