

4FA034301

40W ATTENUATOR 100V LINE - PL140 WITH MESSAGE PRIORITY

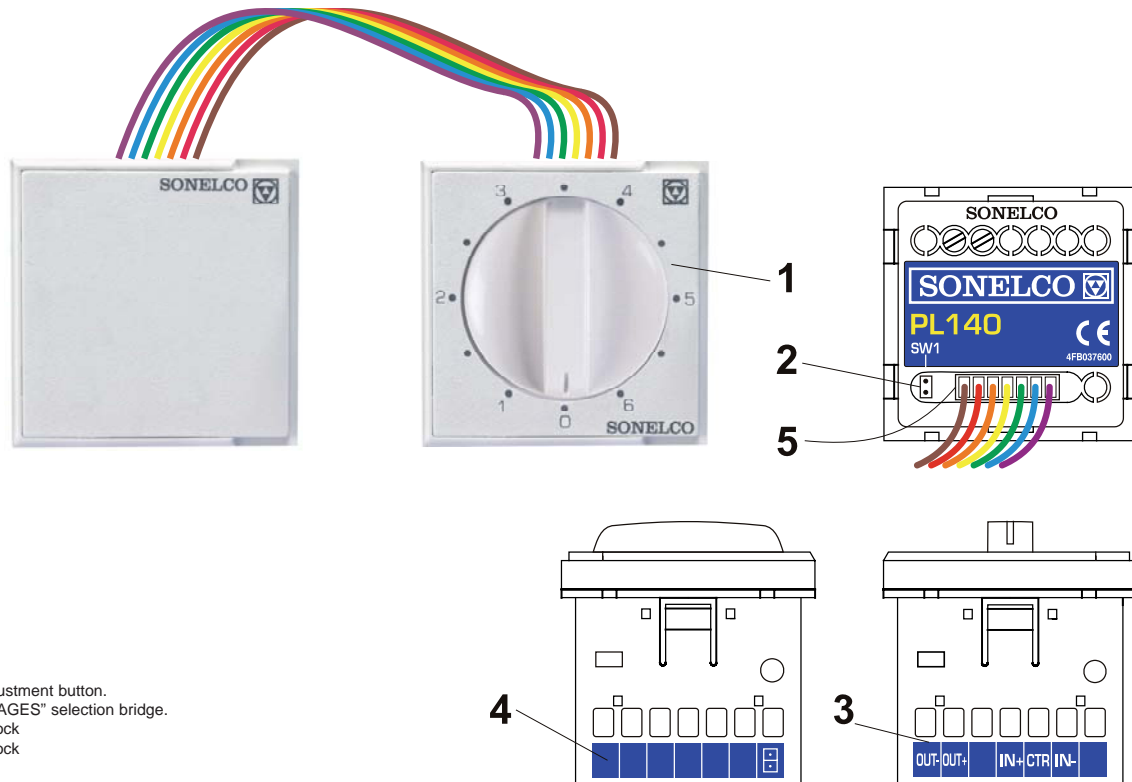

- 1 - Volume adjustment button.
- 2 - "NO MESSAGES" selection bridge.
- 3 - Terminal block
- 4 - Terminal block
- 5 - Connector

DESCRIPTION

Attenuator module with 40W transformer for 100V line with message priority.
With it, 6 output levels can be selected by means of a 12-position rotating selector switch, with a zero between every two levels.

GENERAL CHARACTERISTICS

- Attenuator with transformer for 100V line
- 6 attenuation positions, with a zero between every two levels.
- 12-position rotating selector switch
- Message receipt even when on level 0
- Bridge to select message mode.
- Control Terminal to control the message receipt by external relay (See application diagram)

CONNECTION

Before making the connection make sure the amplifiers of the system are switched off. Make the connection according to the following instructions:

TERMINALS:

- IN+ - + Input, 100V line
- IN- - - Input, 100V line
- CTR - Input for message control by external relay
- OUT+ + Output for 100V line speaker (Max.power 40W)
- OUT- - Output for 100V line speaker (Max.power 40W)

NOTE: The wiring of the system must be installed separately from the power supply, according to regulations.

OPERATION

Once the connection has been made, verify the position of the bridge to choose the **Message** or **No Message** mode.

For **No Messages:** Fit Bridge (preset Factory option)

To receive Messages by relay: Remove bridge and connect control line coming from the message control relay to the CTR strip. (See wiring diagram 1).

With the control button select the desired volume level (1 to 6).

In order to make it easier to use, the regulator button has 12 positions. The ones marked 1, 2, 3, 4, 5 and 6 correspond to 6 volume levels that go from lower to higher.

The intermediate positions correspond to level 0. (Off)

In controls configured to receive messages, even if in 0 position, the messages will be received at maximum level.

Note:

To receive messages with control by relay, a message control relay must be placed at the amplifier output, and terminals IN+, IN- and CTR of all the attenuators, which are going to receive messages, must be connected to the relay terminals.

This relay must be controlled by a voltage that the amplifier must supply when the message is transmitted (See application diagrams).

Sonecco has a relay module for this application.

(Consult the Commercial Dept).

Remember that the maximum charge that you can connect to the output is a 40W diffuser for 100V line or equivalent charge.

TECHNICAL CHARACTERISTICS

Rated input voltage: 100V line

Max. connectable charge to output: 40W/100V line

6 Output Levels: 100V, 50V, 25V, 12.5V, 6.25, 3.125

Output impedance: 250 Ohm

Dimensions: (LxWxD): two 45 x 45mm. modules
Weight: 250grs.

APPLICATION DIAGRAMS

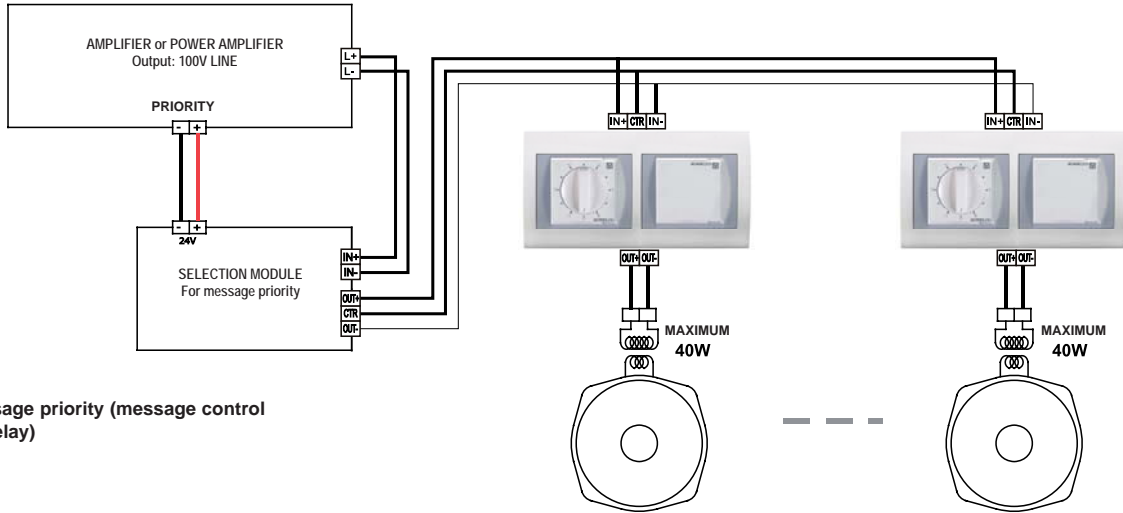

1.- With message priority (message control by external relay)

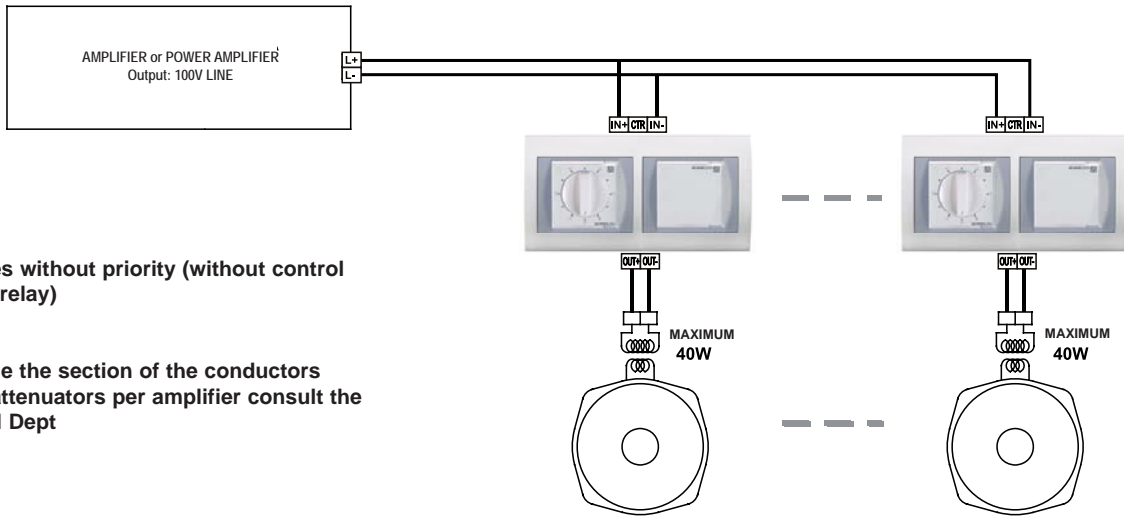

2.- Messages without priority (without control by external relay)

Note:
To determine the section of the conductors and no. of attenuators per amplifier consult the Commercial Dept

ASSEMBLY RECOMMENDATIONS: All the "Prestige Line" series models can be put into place in various types of flush fitted boxes, for which we have several types of front frames available, that can be delivered separately. For further details please www.sonelco.com